

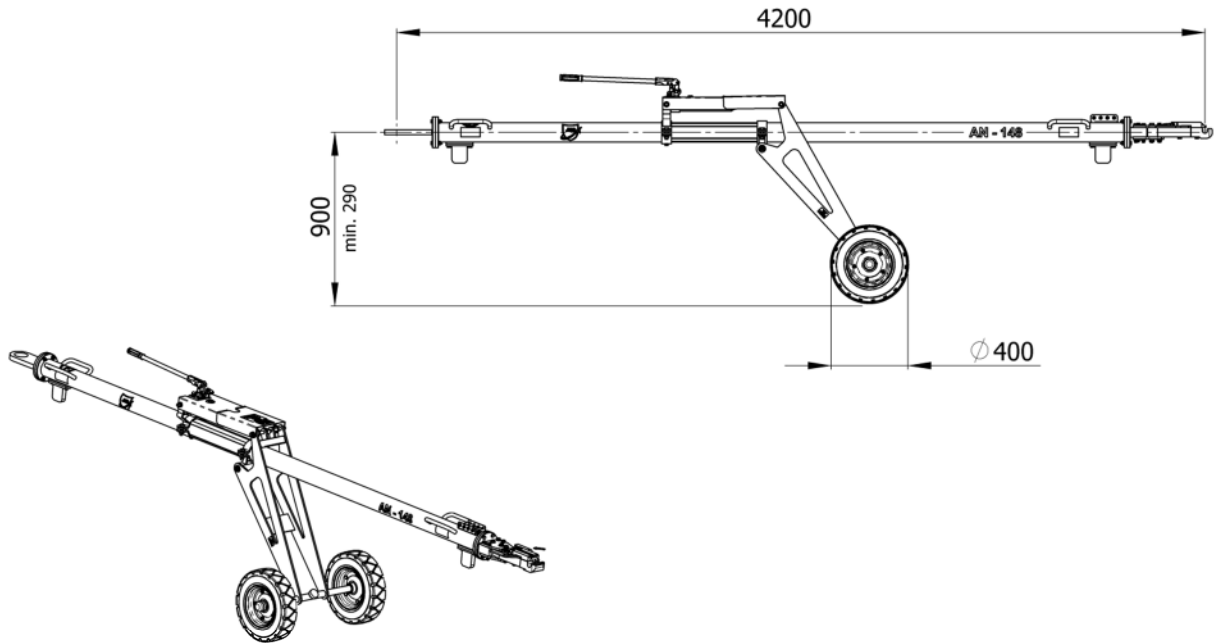

J-TOW148



Standard features:

- Push/Pull and torque shear pin
- 4 spare shear pins included
- Retaining pin
- Air-inflated tires
- Hydraulically height adjustable undercarriage
- Steel tube
- Skydrol resistant paint
- Standard colors: yellow RAL 1007 (tube), black RAL 9004 (undercarriage)

Net weight:

- 145 kg / 320 lbs

Aircraft application:

- Antonov AN-148 / -158

Options (at extra charges):

- Puncture-proof (full rubber) tires
→ Option R4
- Revolving toweye
→ Option CP
- Revolving toweye with shock absorber
→ Option CA
- Customized color for towbar tube i.a.w. RAL coding scheme
→ Option C-RAL

Documentation:

- Technical manual incl. illustrated spare parts list
- COC Certificate of Conformity
- CE Declaration of Conformity (if applicable)

Shear pins / Retaining pin:

- 00.41070.0012 “AK” Push/Pull
- 00.41070.0013 “AL” Torque
- 00.41070.0016 “AK-FB” Retaining pin

Shipping information incl. packing:

Approx. Weight	Approx. shipping Dims l x w x h	Approx. Volume
[kg] 261	[mm] 4320 x 1050 x 965	[m ³] 4,4
[lbs] 575	[inch] 170 x 41 x 38	[ft ³] 155