

## J-TOWbiz3

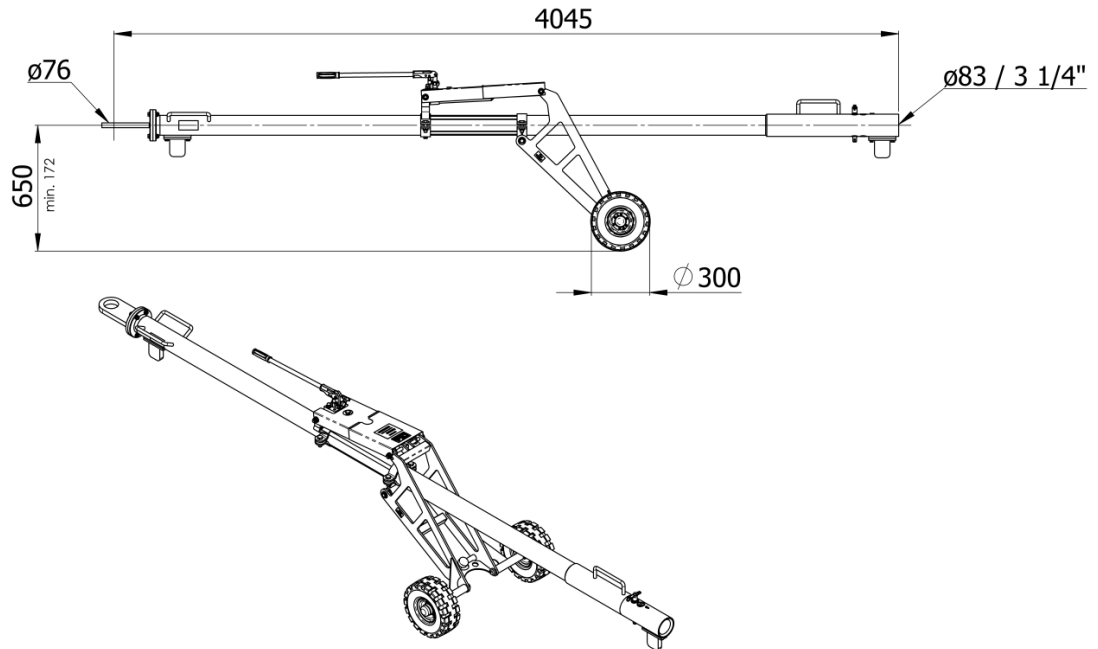

### Standard features:

- Quick release pin for easy towhead replacement
- Air-inflated tires
- Hydraulically height adjustable split undercarriage
- Steel tube
- Skydrol resistant paint
- Standard color:  
 yellow RAL 1007 (tube)  
 black RAL 9004 (undercarriage)
- Compatible to J-TOWheads of JMS D-/E-Series, but also to other universal business jet towheads using a ø83mm / ø3¼" tube lock system

### Net weight: (for towbar without towhead)

- 115 kg / 253 lbs

### Options (at extra charges):

- Adapter for using J-TOWheads with a ø77mm / 3" adapter system.  
 ➔ Adapter D-E
- Adapter for using J-TOWhead-E35/E35.6 with 650mm extension of tow-tube  
 ➔ Adapter E-DM83-650
- Puncture proof tires → Option R3
- Revolving tow eye → Option CP
- Revolving tow eye with shock absorber  
 ➔ Option CA
- Customized color for towbar tube i.a.w. RAL coding scheme  
 ➔ Option C-RAL

### Documentation:

- Technical manual incl. illustrated spare parts list
- COC Certificate of Conformity
- CE Declaration of Conformity (if applicable)

### Shipping information incl. packing: (for towbar without towhead)

Approx. Weight	Approx. shipping Dims l x w x h	Approx. Volume
[kg] <b>231</b>	[mm] <b>4150 x 1050 x 965</b>	[m <sup>3</sup> ] <b>4,2</b>
[lbs] <b>509</b>	[inch] <b>163 x 41 x 38</b>	[ft <sup>3</sup> ] <b>148</b>