

J-TOWcrj

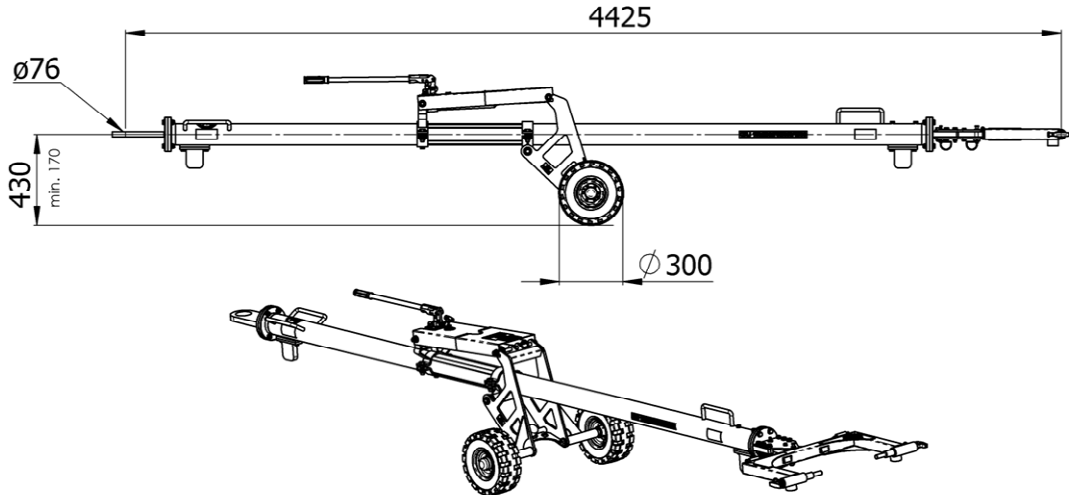

Standard features:

- Push/Pull and torque shear pin
- 2 spare shear pins included
- Retaining pin
- Air-inflated tires
- Hydraulically height adjustable undercarriage
- Steel tube
- Skydrol resistant paint
- Standard colors: yellow RAL 1007 (tube), black RAL 9004 (undercarriage)

Net weight:

- 134 kg / 295 lbs

Aircraft application:

- CRJ100/200/700/900/1000
- Challenger 850, 870, 890
- Hawker 4000

Options (at extra charges):

- Puncture-proof (full rubber) tires
→ Option R3
- Revolving toweye
→ Option CP
- Revolving toweye with shock absorber
→ Option CA
- Revolving towhead
→ Option CD
- Customized color for towbar tube i.a.w. RAL coding scheme
→ Option C-RAL

Documentation:

- Technical manual incl. illustrated spare parts list
- COC Certificate of Conformity
- CE Declaration of Conformity (if applicable)

Shear pins / Retaining pin:

- 20-00930-0020-022 "AX1" for Push/Pull
- 20-00930-0020-027 "AZ1" for Torque
- 20-00930-0020-021 "AX1-FB" Retaining pin

Shipping information incl. packing:

Approx. Weight	Approx. shipping Dims l x w x h	Approx. Volume
[kg] 250	[mm] 4600 x 1050 x 965	[m ³] 4,7
[lbs] 551	[inch] 181 x 41 x 38	[ft ³] 166